

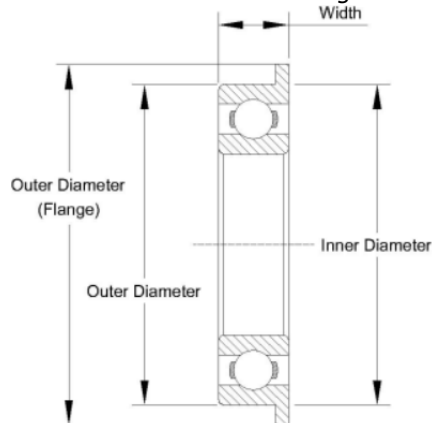

SMF Series Stainless Steel Flanged Miniature Bearings



Part Number	Bore diameter	Outside diameter	Width	Flange outer diameter	Flange thickness	Seal type	Ring material	Ball material	Limiting speed
SMF41x	1.2 mm	4 mm	1.8 mm	4.8 mm	0.4 mm	Open	Stainless Steel	Stainless Steel	99 X 1000 rpm
SMF52	2 mm	5 mm	2 mm	6.2 mm	0.6 mm	Open	Stainless Steel	Stainless Steel	76.5 X 1000 rpm
SMF52 2rs	2 mm	5 mm	2.5 mm	6.2 mm	0.6 mm	Sealed	Stainless Steel	Stainless Steel	76.5 X 1000 rpm
SMF52zz	2 mm	5 mm	2.5 mm	6.2 mm	0.6 mm	Shielded	Stainless Steel	Stainless Steel	76.5 X 1000 rpm
SMF62	2 mm	6 mm	2.5 mm	7.2 mm	0.6 mm	Open	Stainless Steel	Stainless Steel	67.5 X 1000 rpm
SMF62 2rs	2 mm	6 mm	2.5 mm	7.2 mm	0.6 mm	Sealed	Stainless Steel	Stainless Steel	67.5 X 1000 rpm
SMF62zz	2 mm	6 mm	2.5 mm	7.2 mm	0.6 mm	Shielded	Stainless Steel	Stainless Steel	67.5 X 1000 rpm
SMF72	2 mm	7 mm	2.5 mm	8.2 mm	0.6 mm	Open	Stainless Steel	Stainless Steel	56.7 X 1000 rpm
SMF72 2rs	2 mm	7 mm	3 mm	8.2 mm	0.6 mm	Sealed	Stainless Steel	Stainless Steel	56.7 X 1000 rpm
SMF72zz	2 mm	7 mm	3 mm	8.2 mm	0.6 mm	Shielded	Stainless Steel	Stainless Steel	56.7 X 1000 rpm
SMF82x	2.5 mm	8 mm	2.5 mm	9.2 mm	0.6 mm	Open	Stainless Steel	Stainless Steel	63.9 X 1000 rpm
SMF82x 2rs	2.5 mm	8 mm	2.5 mm	9.2 mm	0.6 mm	Sealed	Stainless Steel	Stainless Steel	63.9 X 1000 rpm
SMF82xzz	2.5 mm	8 mm	2.5 mm	9.2 mm	0.6 mm	Shielded	Stainless Steel	Stainless Steel	63.9 X 1000 rpm
SMF63	3 mm	6 mm	2 mm	7.2 mm	0.6 mm	Open	Stainless Steel	Stainless Steel	63.9 X 1000 rpm
SMF63 2rs	3 mm	6 mm	2.5 mm	7.2 mm	0.6 mm	Sealed	Stainless Steel	Stainless Steel	63.9 X 1000 rpm
SMF63zz	3 mm	6 mm	2.5 mm	7.2 mm	0.6 mm	Shielded	Stainless Steel	Stainless Steel	63.9 X 1000 rpm
SMF83	3 mm	8 mm	2.5 mm	9.2 mm	0.6 mm	Open	Stainless Steel	Stainless Steel	54 X 1000 rpm
SMF83 2rs	3 mm	8 mm	3 mm	9.2 mm	0.6 mm	Sealed	Stainless Steel	Stainless Steel	54 X 1000 rpm
SMF83zz	3 mm	8 mm	3 mm	9.2 mm	0.6 mm	Shielded	Stainless Steel	Stainless Steel	54 X 1000 rpm
SMF93	3 mm	9 mm	2.5 mm	10.2 mm	0.6 mm	Open	Stainless Steel	Stainless Steel	50.4 X 1000 rpm
SMF93 2rs	3 mm	9 mm	4 mm	10.6 mm	0.8 mm	Sealed	Stainless Steel	Stainless Steel	50.4 X 1000 rpm
SMF93zz	3 mm	9 mm	4 mm	10.6 mm	0.8 mm	Shielded	Stainless Steel	Stainless Steel	50.4 X 1000 rpm
SMF74	4 mm	7 mm	2 mm	8.2 mm	0.6 mm	Open	Stainless Steel	Stainless Steel	54 X 1000 rpm
SMF74 2rs	4 mm	7 mm	2.5 mm	8.2 mm	0.6 mm	Sealed	Stainless Steel	Stainless Steel	54 X 1000 rpm
SMF74zz	4 mm	7 mm	2.5 mm	8.2 mm	0.6 mm	Shielded	Stainless Steel	Stainless Steel	54 X 1000 rpm
SMF84	4 mm	8 mm	2 mm	9.2 mm	0.6 mm	Open	Stainless Steel	Stainless Steel	50.4 X 1000 rpm
SMF84 2rs	4 mm	8 mm	3 mm	9.2 mm	0.6 mm	Sealed	Stainless Steel	Stainless Steel	50.4 X 1000 rpm
SMF84zz	4 mm	8 mm	3 mm	9.2 mm	0.6 mm	Shielded	Stainless Steel	Stainless Steel	50.4 X 1000 rpm



SMF Series Stainless Steel Flanged Miniature Bearings

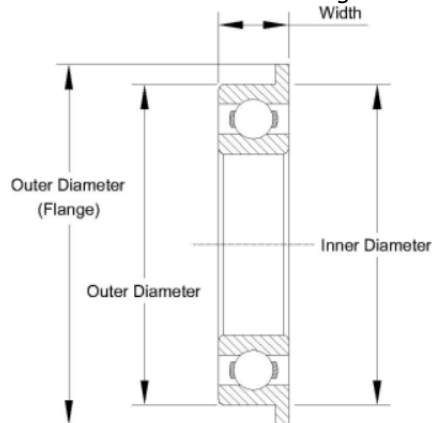

Part Number	Bore diameter	Outside diameter	Width	Flange outer diameter	Flange thickness	Seal type	Ring material	Ball material	Limiting speed
SMF104	4 mm	10 mm	3 mm	11.2 mm	0.6 mm	Open	Stainless Steel	Stainless Steel	43.2 X 1000 rpm
SMF104 2rs	4 mm	10 mm	4 mm	11.6 mm	0.8 mm	Sealed	Stainless Steel	Stainless Steel	43.2 X 1000 rpm
SMF104zz	4 mm	10 mm	4 mm	11.6 mm	0.8 mm	Shielded	Stainless Steel	Stainless Steel	43.2 X 1000 rpm
SMF85	5 mm	8 mm	2 mm	9.2 mm	0.6 mm	Open	Stainless Steel	Stainless Steel	47.7 X 1000 rpm
SMF85 2rs	5 mm	8 mm	2.5 mm	9.2 mm	0.6 mm	Sealed	Stainless Steel	Stainless Steel	47.7 X 1000 rpm
SMF85zz	5 mm	8 mm	2.5 mm	9.2 mm	0.6 mm	Shielded	Stainless Steel	Stainless Steel	47.7 X 1000 rpm
SMF95	5 mm	9 mm	2.5 mm	10.2 mm	0.6 mm	Open	Stainless Steel	Stainless Steel	45 X 1000 rpm
SMF95 2rs	5 mm	9 mm	3 mm	10.2 mm	0.6 mm	Sealed	Stainless Steel	Stainless Steel	45 X 1000 rpm
SMF95zz	5 mm	9 mm	3 mm	10.2 mm	0.6 mm	Shielded	Stainless Steel	Stainless Steel	45 X 1000 rpm
SMF105	5 mm	10 mm	3 mm	11.2 mm	0.6 mm	Open	Stainless Steel	Stainless Steel	45 X 1000 rpm
SMF105 2rs	5 mm	10 mm	4 mm	11.6 mm	0.8 mm	Sealed	Stainless Steel	Stainless Steel	45 X 1000 rpm
SMF105zz	5 mm	10 mm	4 mm	11.6 mm	0.8 mm	Shielded	Stainless Steel	Stainless Steel	45 X 1000 rpm
SMF115	5 mm	11 mm	4 mm	12.6 mm	0.8 mm	Open	Stainless Steel	Stainless Steel	40.5 X 1000 rpm
SMF115 2rs	5 mm	11 mm	4 mm	12.6 mm	0.8 mm	Sealed	Stainless Steel	Stainless Steel	40.5 X 1000 rpm
SMF115zz	5 mm	11 mm	4 mm	12.6 mm	0.8 mm	Shielded	Stainless Steel	Stainless Steel	40.5 X 1000 rpm
SMF106	6 mm	10 mm	2.5 mm	11.2 mm	0.6 mm	Open	Stainless Steel	Stainless Steel	40.5 X 1000 rpm
SMF106 2rs	6 mm	10 mm	3 mm	11.2 mm	0.6 mm	Sealed	Stainless Steel	Stainless Steel	40.5 X 1000 rpm
SMF106zz	6 mm	10 mm	3 mm	11.2 mm	0.6 mm	Shielded	Stainless Steel	Stainless Steel	40.5 X 1000 rpm
SMF126	6 mm	12 mm	3 mm	13.2 mm	0.6 mm	Open	Stainless Steel	Stainless Steel	38.7 X 1000 rpm
SMF126 2rs	6 mm	12 mm	4 mm	13.6 mm	0.8 mm	Sealed	Stainless Steel	Stainless Steel	38.7 X 1000 rpm
SMF126zz	6 mm	12 mm	4 mm	13.6 mm	0.8 mm	Shielded	Stainless Steel	Stainless Steel	38.7 X 1000 rpm
SMF117	7 mm	11 mm	2.5 mm	12.2 mm	0.6 mm	Open	Stainless Steel	Stainless Steel	38.7 X 1000 rpm
SMF117 2rs	7 mm	11 mm	3 mm	12.2 mm	0.6 mm	Sealed	Stainless Steel	Stainless Steel	38.7 X 1000 rpm
SMF117zz	7 mm	11 mm	3 mm	12.2 mm	0.6 mm	Shielded	Stainless Steel	Stainless Steel	38.7 X 1000 rpm
SMF137	7 mm	13 mm	3 mm	14.2 mm	0.6 mm	Open	Stainless Steel	Stainless Steel	36 X 1000 rpm
SMF137 2rs	7 mm	13 mm	4 mm	14.6 mm	0.8 mm	Sealed	Stainless Steel	Stainless Steel	36 X 1000 rpm
SMF137zz	7 mm	13 mm	4 mm	14.6 mm	0.8 mm	Shielded	Stainless Steel	Stainless Steel	36 X 1000 rpm
SMF128	8 mm	12 mm	2.5 mm	13.2 mm	0.6 mm	Open	Stainless Steel	Stainless Steel	36 X 1000 rpm



SMF Series Stainless Steel Flanged Miniature Bearings

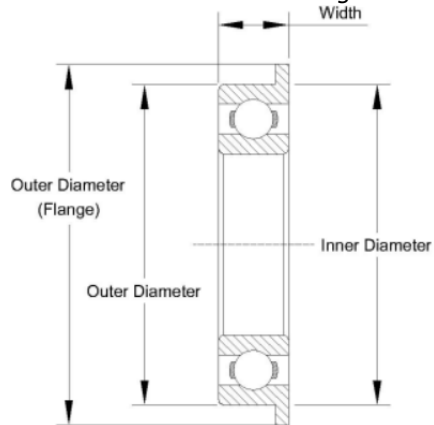

Part Number	Bore diameter	Outside diameter	Width	Flange outer diameter	Flange thickness	Seal type	Ring material	Ball material	Limiting speed
SMF128 2rs	8 mm	12 mm	3.5 mm	13.6 mm	0.8 mm	Sealed	Stainless Steel	Stainless Steel	36 X 1000 rpm
SMF128zz	8 mm	12 mm	3.5 mm	13.6 mm	0.8 mm	Shielded	Stainless Steel	Stainless Steel	36 X 1000 rpm
SMF148	8 mm	14 mm	3.5 mm	15.6 mm	0.8 mm	Open	Stainless Steel	Stainless Steel	34.2 X 1000 rpm
SMF148 2rs	8 mm	14 mm	4 mm	15.6 mm	0.8 mm	Sealed	Stainless Steel	Stainless Steel	34.2 X 1000 rpm
SMF148zz	8 mm	14 mm	4 mm	15.6 mm	0.8 mm	Shielded	Stainless Steel	Stainless Steel	34.2 X 1000 rpm